



Theatre Virtual Learning

Introduction to Theatre Design & Production

The Aesthetics of Set Design

Date: May 15, 2020



Lesson: May 15, 2020

Objective/Learning Target:

The student will use creativity and problem solving to complete a FUN technical challenge!

The aesthetics of set design!

Let's Get Started / Warm Up Activities:

Can you think of a movie title that best describes your life currently?



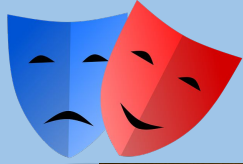

Lesson Steps: 3D Model Challenge

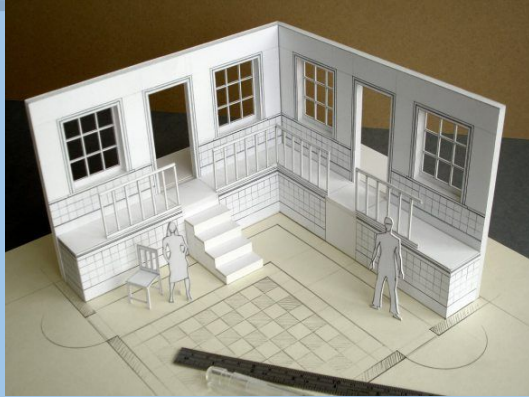

When designing a space, set designers use set models to share their design interpretations.

These can be anything from a simplified white card model to a very detailed model.

Q: Why are they so useful and important?

A: They clearly communicate the vision of the designer!!!



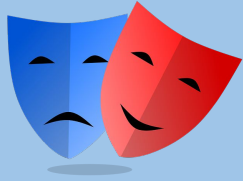

Practice: Tech Challenge

Set Model Challenge

1. Pick one scene from any play, movie, TV show, cartoon, book, or video game.
2. Now it is your task to recreate the scene in a set model being creative and using supplies you have at home. This could be anything: legos, toys, cardboard, etc.
3. Once you are done, write a paragraph describing your scene and how you developed your model. In other words, what was your process?
4. Take a picture and share it!



Example: *Indiana Jones*